



# 806LED-346B HARBORTOWN SERIES

LED BOLLARDS

**DIMENSIONS**  
9-1/2" Ø  
24" to 48"  
TALL

**7 YEAR WARRANTY**

**LUMEN RANGE**  
455 to  
1,005

**LIFE SPAN**  
L70  
MINIMUM  
100,000  
HOURS

**UL LISTED**

**CLICK FOR FAQ'S**

JOB NAME \_\_\_\_\_

FIXTURE TYPE \_\_\_\_\_

MEMO \_\_\_\_\_

## BUILD A PART NUMBER

ORDERING EXAMPLE: **806LED-346B-48"-IL40T5-MDLO4-CL2/BKT**

Model	Height	LED	CCT	Type	Driver	Option Chain Loop	Option Fuse	Option Photocell	Option Ground Fault Breaker	Finish

### Model

- 806LED-346B

### Overall Height (In Inches)

- \_\_\_" (Available from 24"-48")

### LED

- IL

### CCT - Color Temperature (K)

- 27(00)
- 30(00)
- 40(00)
- 50(00)

### Type

- T2
- T3
- T4
- T5

### Driver

- MDLO2 (120v-277v, 200mA)
- MDLO4 (120v-277v, 400mA)
- MDH02 (347v-480v, 200mA)
- MDH04 (347v-480v, 400mA)

### Options (Click here to view paint options sheet)

- CL1 Single Chain Loop
- CL2 Double Chain Loops at 180°
- FHD<sup>1</sup> Double Fuse and Holder
- PEC Electronic Button Photocontrol (120v-277v)
- PEC4 Electronic Button Photocontrol (480v)
- GFI IUC 15 Amp duplex GFCI receptacles with a standard in-use cover
- GFI LPIUC 15 Amp duplex GFCI receptacles with a low-profile in-use cover

<sup>1</sup>Ships loose for installation in base.

### Finish

#### Standard Finishes<sup>2</sup> (Click here to view paint finish sheet)

- BKT Black Textured
- WHT White Textured
- PGT Park Green Textured

- ABZT Architectural Medium Bronze Textured
- DBT Dark Bronze Textured

<sup>2</sup>Smooth finishes are available upon request.

#### Sternberg Select Finishes

- VG Verde Green
- SI Swedish Iron
- OWGT Old World Gray Textured

#### Sternberg Urban Finishes

(Click here to view paint finish sheet)

- UGMT Gun Metal Textured
- UGM Gun Metal Matte
- UBT Urban Bronze Textured
- UB Urban Bronze Matte
- ULBT Urban Light Bronze Textured
- ULB Urban Light Bronze Matte
- USLT Urban Silver Textured
- USL Urban Silver Matte
- UWHT Urban White Textured
- UWH Urban White Matte
- UCHS Urban Champagne Satin Smooth

#### Custom Finishes<sup>3</sup>

- CM Custom Match
- OI Old Iron
- RT Rust
- WBR Weathered Brown
- CD Cedar
- WBK Weathered Black
- TT Two Tone

<sup>3</sup>Custom colors require upcharge.

## Specifications

### General

The decorative LED bollard is a small scale, maritime theme design. It features a cylindrical body, decorative aluminum cage, dome roof and a clear glass Fresnel lens. The bollard shall be UL listed in US and Canada.

### Construction

The bollard shaft shall be 6" diameter extruded round tubing having a wall thickness of .250" and made of ASTM 6063 extruded aluminum and tempered to a T6 condition. The shaft will be appointed with an LED head, the fitter portion shall have four (4) stainless steel allen head screws which secures the connection.

### LED's

The luminaire shall use high output, high brightness LED's, consisting of a two piece assembly complete with Chip on Board (COB) LED component and COB holder frame. The LED's and printed circuit boards shall be 100% recyclable; they shall also be protected from moisture and corrosion by a conformal coating of 1 to 3 mils. They shall not contain lead, mercury or any other hazardous substances and shall be RoHS compliant. The LED life rating data shall be determined in accordance with IESNA LM-80. The High Performance white LED's will have a life expectancy of approximately 100,000 hours with not less than 70% of original brightness (lumen maintenance), rated at 25°C. The High Brightness, High Output LED's shall be 4000K (2700K, 3000K or 5000K option) color temperature with a minimum of 70 CRI. Consult factory for custom color CCT. The luminaire shall have a minimum \_\_\_\_\_ (see table) delivered initial lumen rating when operated at steady state with an average ambient temperature of 25°C (77°F).

### Optics

The luminaire shall be provided with individual, molded silicone refractor type optics applied to each COB (Chip On Board) LED assembly. The optic shall be at least 92% efficient while providing superior thermal, UV and impact resistance for the COB assembly.

*See next page*

# 806LED-346B HARBORTOWN SERIES

## LED BOLLARDS

The optic ensures precise light control while providing cutoff control that limits or contains up-light. The luminaire shall provide Type \_\_\_\_ (2, 3, 4 or 5) light distribution per the IESNA classifications. Testing shall be done in accordance with IESNA LM-79.

### Electronic Driver

The LED driver shall be U.L. Recognized. It shall be securely mounted inside the bollard, for optimized performance and longevity. It shall be supplied with a quick-disconnect electrical connector on the power supply, providing easy power connections and fixture installation. It shall have overload as well as short circuit protection, and have a DC voltage output, constant current design, 50/60HZ. It shall be supplied with line-ground, line-neutral and

neutral-ground electrical surge protection in accordance with IEEE/ANSI C62.41.2 guidelines. It shall be dimmable using a 0-10v signal. The driver shall have a minimum efficiency of 88%.

### Installation

Four 3/8" diameter, hot-dipped galvanized "L" type anchor bolts shall be provided with the bollard for anchorage, they shall be mounted in a 3-1/4" bolt circle. The separate anchor base shall be 6" diameter and made of heavy wall, 319 alloy cast aluminum with a 5/8" thick floor. It shall be vertically fastened to bollard housing shaft with eight (8) stainless steel allen head screws.

### Photocell

The photocell shall be mounted on the bollard shaft on an access plate. The electronic button type photocell is instant on with a 5-10 second turn off, and shall turn on at 1.5 footcandles with a turn-off at 2-3 footcandles. Photocell is 120-277 volt and warranted for 6 years.

### Warranty

Seven-year limited warranty. See product and finish warranty guide for details.

### Finish

Refer to website for details.

3-1/4" Bolt Circle

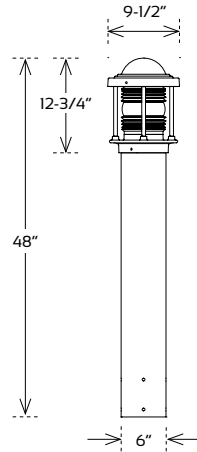
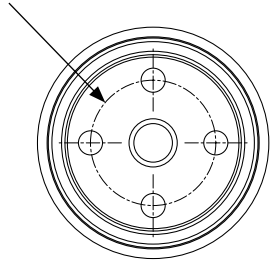

806LED-346B-48"

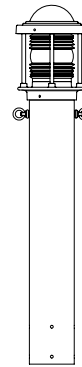

CL2  
OPTIONAL  
CHAIN LOOPS

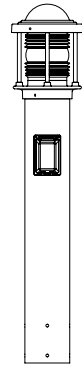

GFI LPIUC  
OPTIONAL  
DUPLEX RECEPTACLE

## Performance

LIGHT SOURCE	T3 DELIVERED LUMENS	EFFICACY (LPW)	T4 DELIVERED LUMENS	EFFICACY (LPW)	T5 DELIVERED LUMENS	EFFICACY (LPW)	WATTAGE
1L27T_-MDL04	805	47.4	845	49.7	865	50.9	17
1L30T_-MDL04	905	53.2	950	55.9	975	57.4	17
1L40T_-MDL04	935	55.0	980	57.6	1005	59.1	17
1L27T_-MDL02	455	45.5	480	48.0	490	49.0	10
1L30T_-MDL02	510	51.0	540	54.0	550	55.0	10
1L40T_-MDL02	525	52.5	555	55.5	565	56.5	10